

KEEP SALEM MOVING!

**Proposed City of Salem November 2008 Streets and Bridges General Obligation Bond
Total Proposed Bonding Authority: \$99.8 million**

Project Summary:

Market Street NE/Swegle Road NE Realignment and Corridor Safety Project

Project Description: Construct Market Street NE and Swegle Road NE to Minor Arterial Street standards with center turn lane, proper travel lane widths, bicycle lanes, curbs, gutters, sidewalks, drainage, streetlights, and landscaping, as needed. Realign Market Street NE and Swegle Road NE to create a single signalized intersection with 45th Avenue NE, replacing the two existing stop-controlled intersections. Construct cul-de-sac streets to serve Swegle Elementary School and adjacent properties, previously accessed by Market Street NE and Swegle Road NE. Make needed traffic signal modifications at the intersection of Market Street NE and Lancaster Drive NE, as well as other project modifications as needed.

Background: Market Street NE is classified as a Minor Arterial street, east of Lancaster Drive NE, and carries 10,000 vehicles per day. Swegle Road NE is classified as a Minor Arterial street and carries 6,000 vehicles per day.

Estimated Project Costs: \$10.84 million (constructed)

Draft Construction Schedule: Begin Design and Right-of-Way Acquisition: 2010
Begin Construction: 2013

Neighborhood Association: East Lancaster Neighborhood Association (ELNA)

City Council Ward: Ward 6, Councilor Bruce Rogers

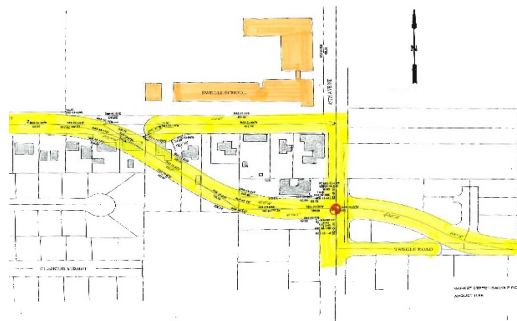
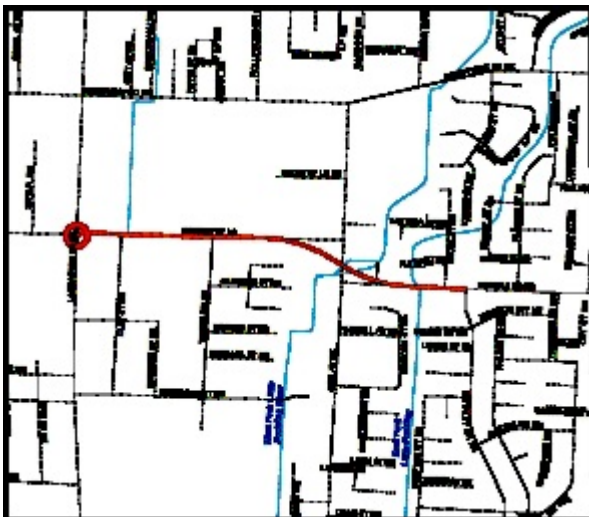

For more information contact Mark Becktel, Transportation Services Manager, City of Salem Public Works Department, 555 Liberty Street SE, Room 325, Salem, OR 97301, telephone 503-588-6211 or e-mail at mbecktel@cityofsalem.net