

ORDINANCE NO. 108-07

AN ORDINANCE ASSESSING FOR AN EXISTING SEWER LINE AGAINST BENEFITTED PROPERTY LOCATED AT **4821 SWEGLE ROAD SE**, CITY OF SALEM, OREGON; MAKING PROVISIONS THEREFOR; AND DECLARING AN EMERGENCY.

Whereas, under the provisions of SRC 21.340 a property owner in lieu of paying a connection fee to connect property to the city sewer system may make application to pay the fee in installments as provided by the Bancroft Bonding Act; and

Whereas, such an application has been made necessitating the placement upon the benefitted property of an assessment equal to the total amount of the connection fee;

NOW, THEREFORE, THE CITY OF SALEM ORDAINS AS FOLLOWS:

Section 1. That there hereby is assessed upon and declared to be a lien against the parcel of land in the tabulated statement herein set forth the sum in the column opposite the description of said parcel, to-wit:

////

////

////

////

////

////

////

////

////

////

////

////

////

////

	<u>Frontage</u>	<u>Total Cost</u>
Viktor S. Sakaly 5115 Yukon Court NE Salem, Oregon 97305	<u>55.02</u>	<u>\$2,435.74</u>

Tax Lot No. 072W20BC07042, R341181

The northerly 60.71 feet of Parcel 3, Partition Plat No. 2007- 047,
and recorded in Reel 2795, Page 077, Marion County Records,
Oregon.

TOTALS:	<u>55.02</u>	<u>\$2,435.74</u>
----------------	--------------	-------------------

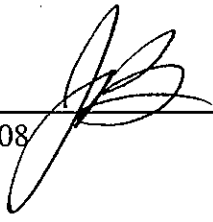
Checked By:  _____
 Project No.: 791008
 August 1, 2007

1 **Section 2.** That the Director of Finance is directed to enter in the lien docket of the City of Salem a
2 statement of said assessment made by this ordinance, the same to be entered in due and regular form as
3 provided by the charter and ordinances of the City of Salem.

4 **Section 3.** That the Director of Finance hereby is directed to prepare and to serve upon such owner a notice
5 of such assessment and lien.

6 **Section 4.** This act being necessary for the immediate preservation of the public peace, health, and safety
7 an emergency is hereby declared to exist, and this ordinance shall be in full force and effect from and after
8 the date of its passage.

9 PASSED by the Council this _____ day of _____, 2006.

10
11 ATTEST:

12
13 City Recorder

14 Approved by City Attorney:  _____

15
16
17 G:\Group\LEGAL\Council\081307 4821 Swegle Rd SE sewer con ord.wpd

FOR COUNCIL MEETING OF: August 13, 2007
AGENDA ITEM NO.: 8.1 (d)
PUBLIC WORKS FILE NO.: 791008

TO: MAYOR AND CITY COUNCIL
THROUGH: ROBERT G. WELLS, CITY MANAGER

FROM: TIM GERLING, P.E., DIRECTOR
PUBLIC WORKS DEPARTMENT

SUBJECT: SEWER CONNECTION FEE INSTALLMENT PAYMENT FOR
4821 SWEGLE ROAD SE

ISSUE:

Payment of connection fee in installments for property now being developed.

RECOMMENDATION:

It is recommended Council approve the Ordinance Bill establishing the connection fee, thus permitting said fee to be paid in installments.

BACKGROUND:

As provided in SRC 21.230, it is the policy of the City of Salem to charge a connection fee for a sewer connection when the subject property has not been previously assessed. When an owner requests to pay connection fees in installments, SRC 21.230(c) provides for processing connection fees as follows such that a lien can be placed on the benefited property until the installments are paid:

1. First Reading of Ordinance Bill
2. Second Reading of Ordinance Bill—Final Passage

The property proposed to be charged under this ordinance is served by a sewer line constructed in 1991.

FACTS AND FINDINGS:

The property is now being developed and is being charged a connection fee of \$2,435.74 as its proportionate share of the cost of sewer services provided.

Since this sewer line was not constructed through an assessment district, this connection fee is based upon the average cost for constructing an eight-inch sewer line for the previous year.

James L. Bonnet, P.E.
City Engineer

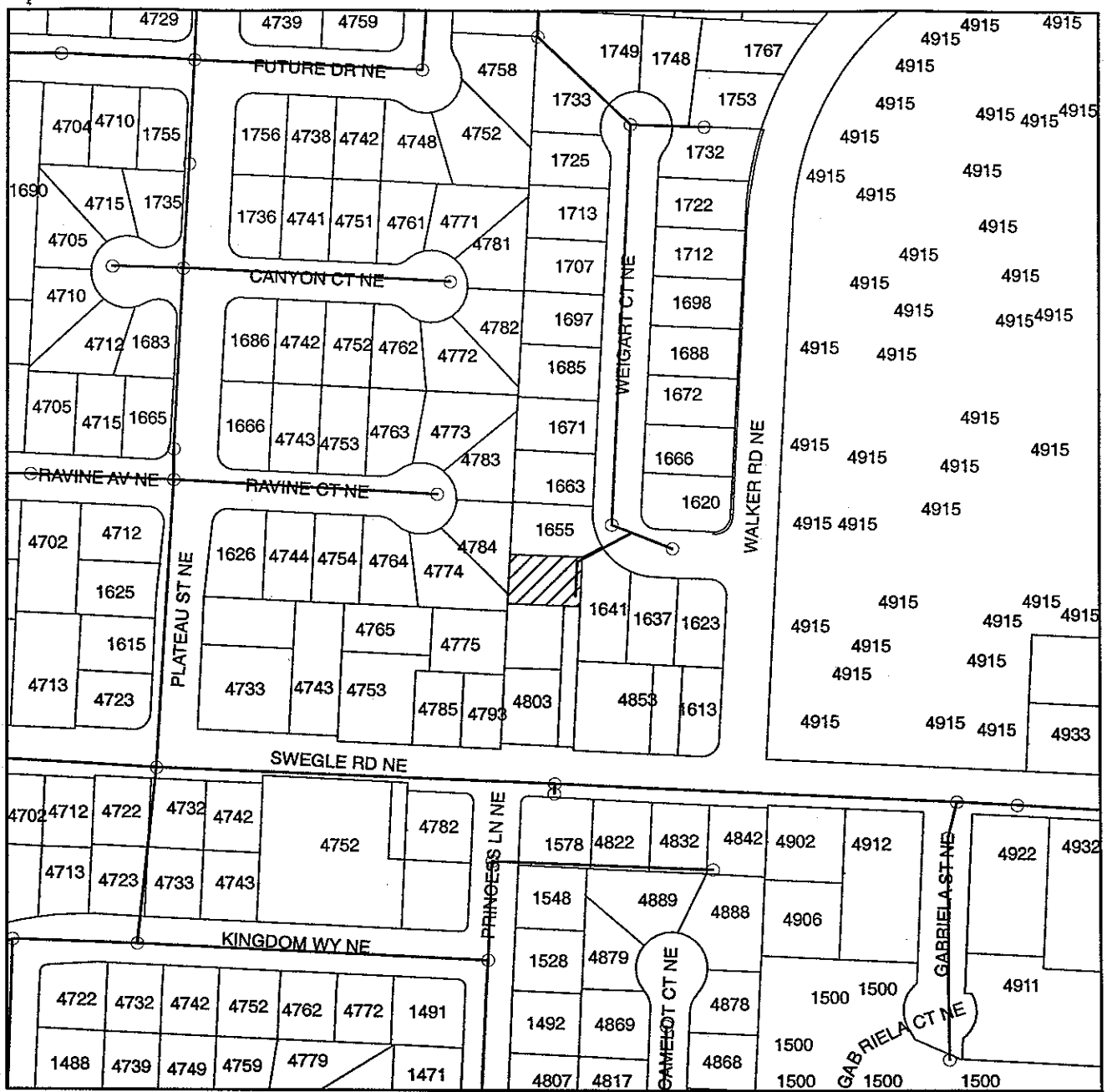

4821 SWEGLE ROAD NE
 PARCEL 3 P. P. 2007-047
 072W20BC07042, R341181
 REEL 2816 page 151
 WARD 6

SEWER

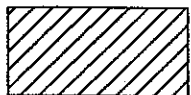

PROPERTY WHERE CITY IS
 COLLECTING A CONNECTION FEE



SCALE: 1" = 200"

EXHIBIT MAP