

RESOLUTION NO. 2008-25

THE CITY OF SALEM RESOLVES AS FOLLOWS:

Section 1. THAT property located at the 23rd Street SE extension, Oxford Street SE to Mission Street SE, as legally described in Exhibit A, attached hereto and incorporated herein by reference, be and the same is hereby dedicated for street and right-of-way.

Section 2. This resolution is effective upon adoption.

ADOPTED by the Council this _____ day of _____, 2008.

ATTEST:

CITY RECORDER

Approved by City Attorney: _____



Checked by: Jon Bolliger

Street Right-of-Way Dedication by City of Salem
an Oregon Municipal Corporation

Beginning at a point on the North boundary line of Amended Plat of NEW HAVEN marking the Southwest corner of Parcel 1 as described in Reel 1964, Page 330, Deed Records for Marion County, Oregon, which point bears South 89°51'55" West 600.97 feet from the Northeast corner of said Amended Plat of NEW HAVEN and being situated in the Northeast Quarter of Section 35, Township 7 South, Range 3 West of the Willamette Meridian in the City of Salem, Marion County, Oregon;

thence North 00°53'08" West along the West line of said Parcel 1, a distance of 274.46 feet to the TRUE POINT OF BEGINNING;

thence northwesterly along the arc of a 272.50 foot radius curve to the right (the chord of which bears North 12°37'04" West 110.87 feet) a distance of 111.65 feet;

thence North 00°52'48" West 10.88 feet;

thence northeasterly along the arc of a 272.50 foot radius curve to the right (the chord of which bears North 10°51'07" East 110.82 feet) a distance of 111.60 feet to the West line of said Parcel 1;

thence South 00°53'08" East along said West line, a distance of 227.94 feet to the TRUE POINT OF BEGINNING.

Contains 0.0812 acres of land or 3537 square feet of land.

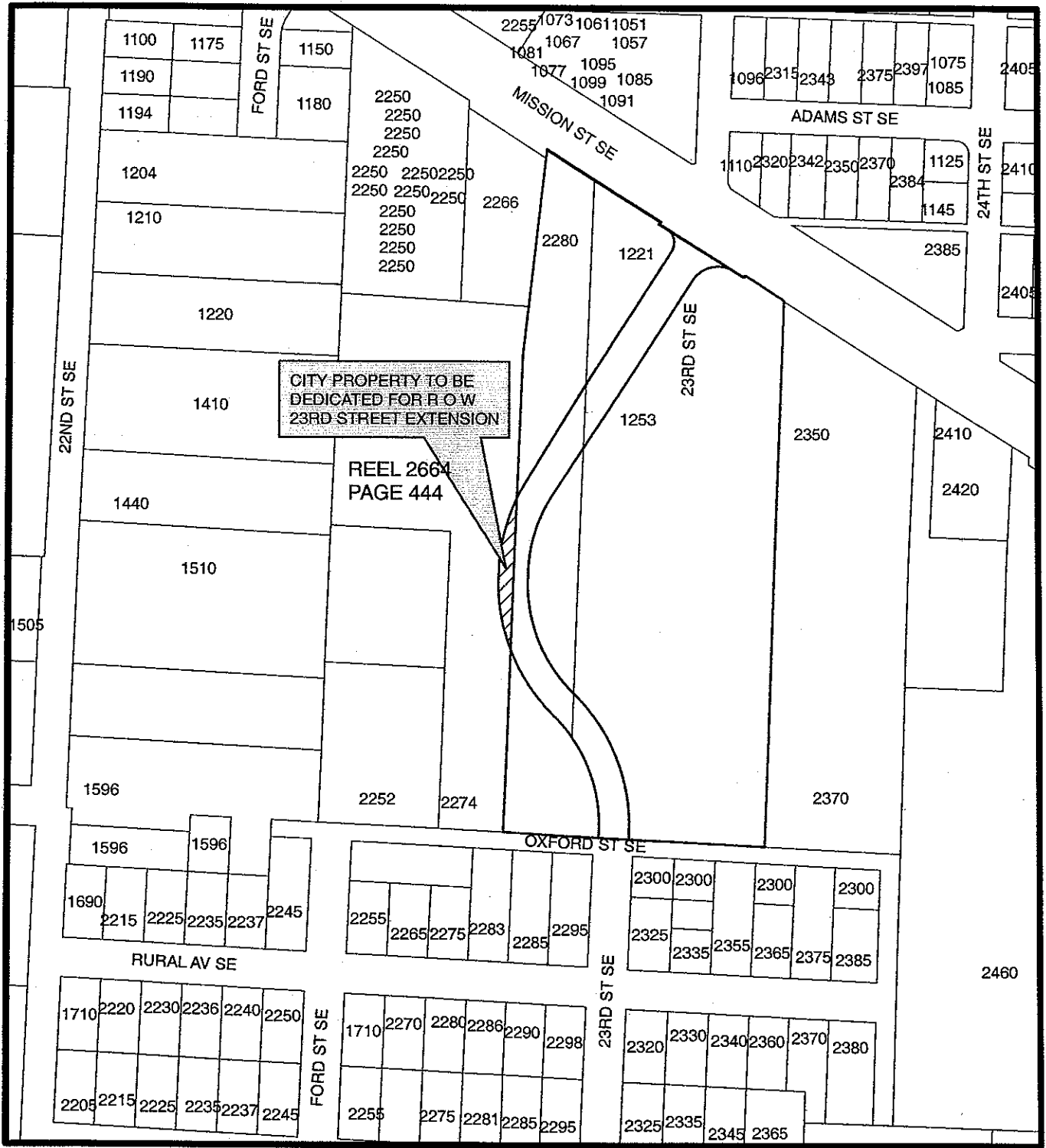

FOR INFORMATION ONLY

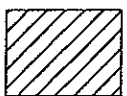

CITY PROPERTY TO BE
DEDICATED FOR 23RD STREET
EXTENSION TO MISSION STREET



SCALE: 1' = 200'