

**RESOLUTION NO. 2008-31**

THE CITY OF SALEM RESOLVES AS FOLLOWS:

**Section 1.** THAT property located on Marine Drive NW, south off Glen Creek Road NW, southerly to the intersection of the Southern Pacific Railroad right-of-way, legally described in "Exhibit A," attached hereto and by this reference incorporated herein, be and the same is hereby dedicated for street and right-of-way.

**Section 2.** This resolution is effective upon adoption.

ADOPTED by the Council this \_\_\_\_\_ day of \_\_\_\_\_, 2008.

ATTEST:

CITY RECORDER

Approved by City Attorney: \_\_\_\_\_



Checked by: Jon Bolliger

EXHIBIT A

Beginning at a 5/8-inch iron rod with aluminum cap stamped City of Salem (C.S. 11782) on the North Line of the James White Donation Land Claim No. 61; said point being 870.98 feet North 89° 48' 56" West from the northeast corner of said Donation Land Claim No. 61, being in Section 22, Township 7 South, Range 3 West of the Willamette Meridian, City of Salem, Polk County, Oregon; said point also being the northeast corner of Lot 1, Orchard Company Addition, as recorded in Book 1, Page 41, Book of Town Plats, Polk County, Oregon; and running thence: South 01° 51' 40" West 884.08 feet, more or less, along the East Line of Lots 1-6 and the southerly extension of said Lot 6 and the West Line of that tract of land described in that instrument recorded in Deed Volume 191, Page 107, Deed Records, Polk County, Oregon, to a point on the Old Southern Pacific Railroad Right-of-way; thence along the arc of a 602.958-foot radius curve to the right (the chord of which bears North 70° 08' 27" East 64.59 feet) 64.62 feet; said point being 60 feet Easterly if measured perpendicular thereto from the East Line of said Orchard Company Addition and Deed Volume 191, Page 107; thence North 01° 51' 40" East 861.94 feet parallel with the East Line of said Orchard Company Addition and Deed Volume 191, Page 107, to a point on the North Line of said James White Donation Land Claim No. 61; thence North 89° 48' 56" West 60.03 feet along the Donation Land Claim Line to the Point of Beginning.

Containing 1.2016 acres of land, more or less.

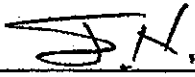
Checked By:   
Project No.: None  
April 2, 2008

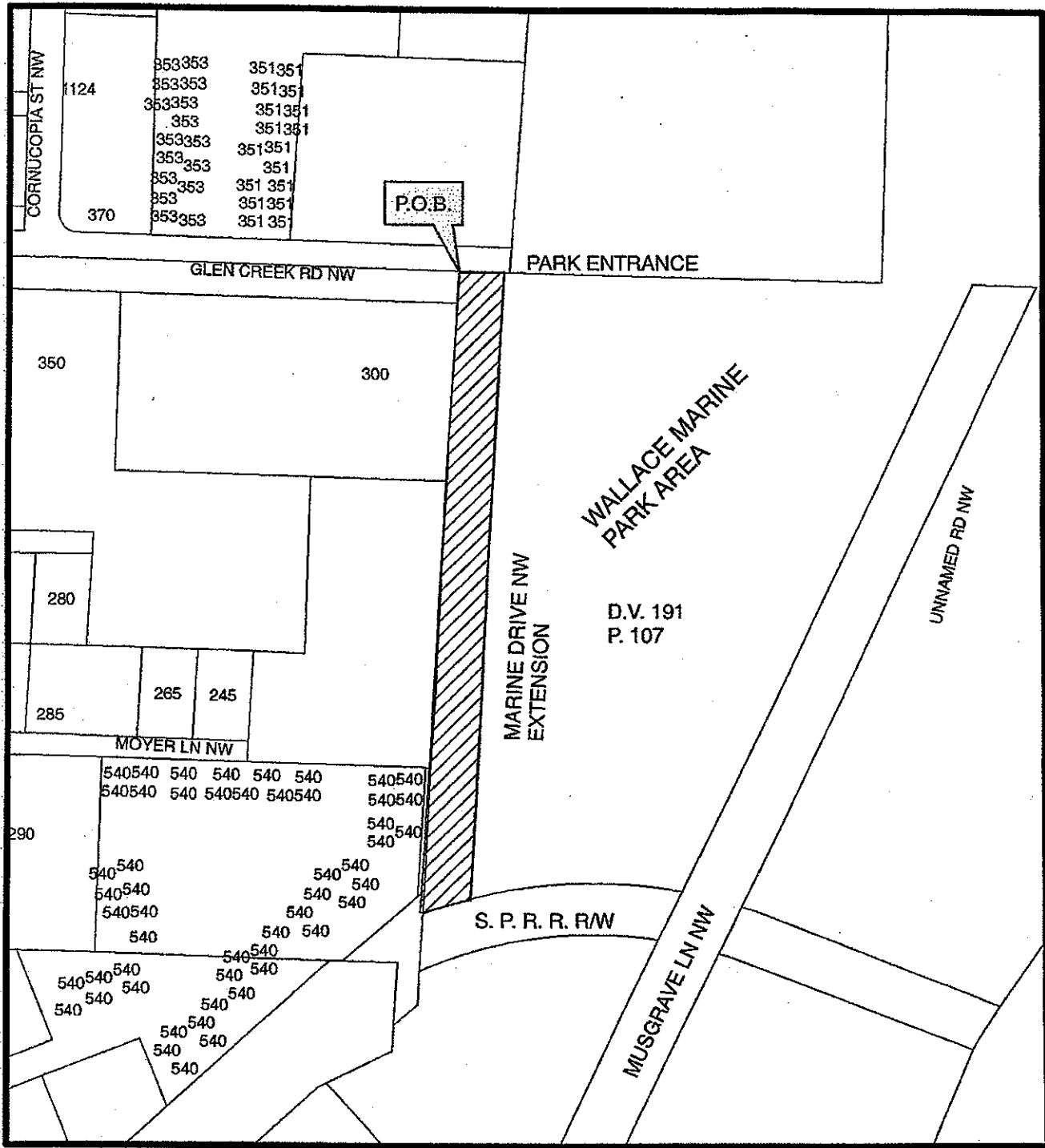

## EXHIBIT MAP "B"



CITY PROPERTY TO BE  
DEDICATED FOR THE  
EXTENSION OF  
MARINE DRIVE NW



SCALE: 1' = 200'

FOR INFORMATION ONLY