

BEAM TO POST CONNECTION WITH PLYWOOD GUSSETS

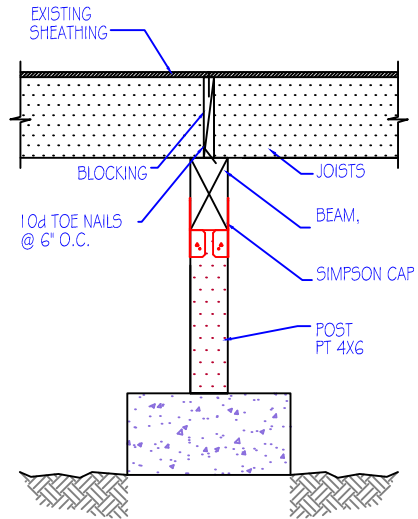

BEAM TO POST CONNECTION WITH SIMPSON AC CAP

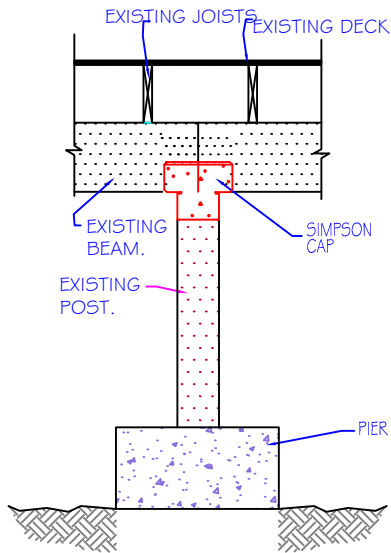

CITY OF SALEM
COMMUNITY DEVELOPMENT DEPARTMENT
BUILDING AND SAFETY DIVISION

555 LIBERTY STREET SE ROOM 320
SALEM OREGON 97301-3513
TEL: (503) 588-6256

STANDARD DETAIL

BEAM/POST CONNECTION

| | |
|--------------|--------|
| Revised: | Number |
| Project No.: | 13 |
| Date: | |
| Scale: | |