

SK-1 (FAP PLATE)



SK-2 (TITEN SCREW)



SK-3 (SDS SCREW)

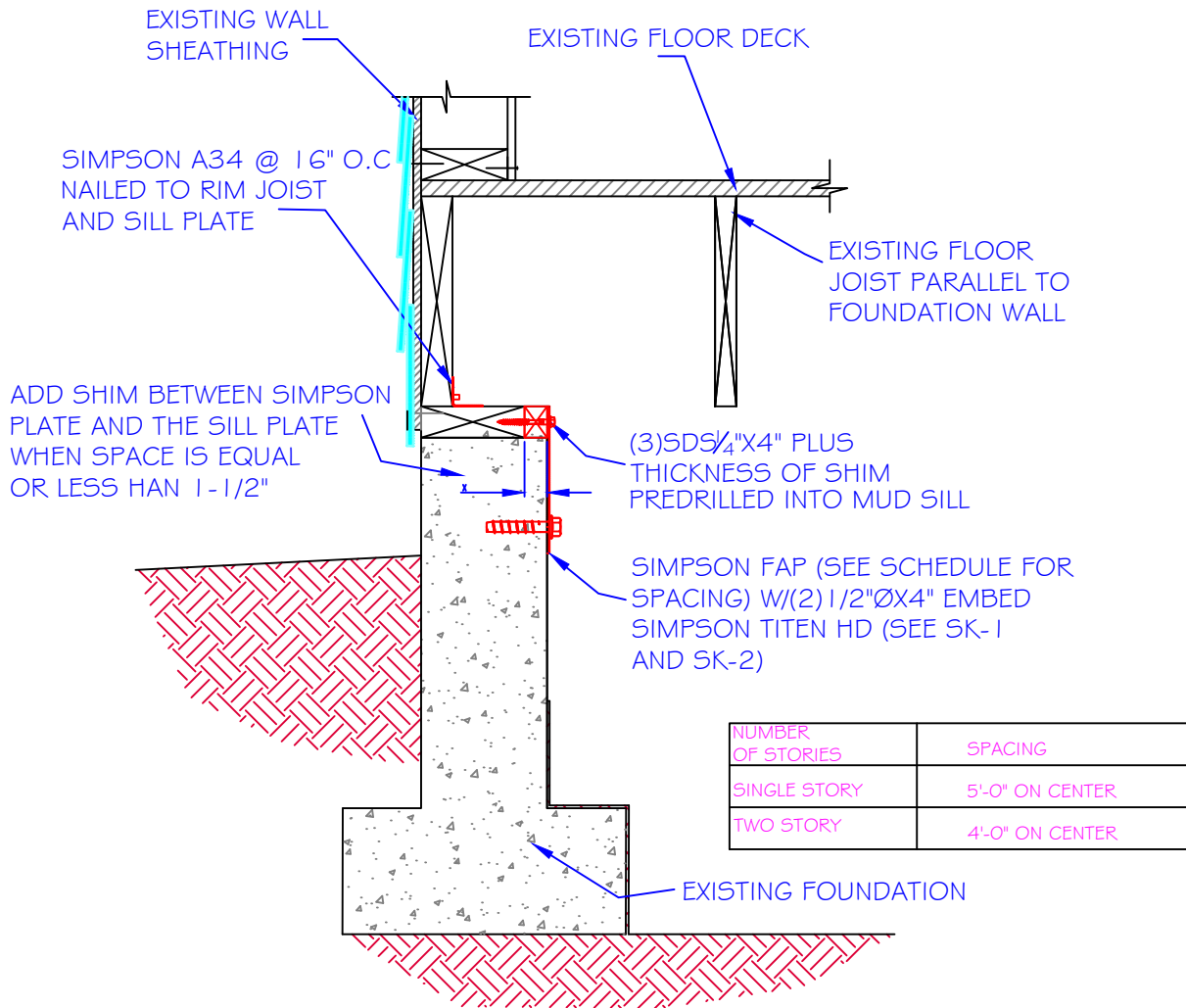

| NUMBER OF STORIES | SPACING         |
|-------------------|-----------------|
| SINGLE STORY      | 5'-0" ON CENTER |
| TWO STORY         | 4'-0" ON CENTER |

**SILL PLATE TO FOUNDATION CONNECTION W/FAP  
FLOOR FRAMING PARALLEL TO STEM WALL**



CITY OF SALEM  
COMMUNITY DEVELOPMENT DEPARTMENT  
BUILDING AND SAFETY DIVISION

555 LIBERTY STREET SE ROOM 320  
SALEM OREGON 97301-3513  
TEL: (503) 588-6256

STANDARD DETAIL

SILL PLATE/MUDSILL TO FOUNDATION  
CONNECTION WITH SIMPSON STRONG  
TIE FAB FOUNDATION ANCHOR PLATE

- FAP FOUNDATION ANCHOR PLATE

|              |        |
|--------------|--------|
| Revised:     | Number |
| Project No.: | 1      |
| Date:        |        |
| Scale:       |        |